

OCULARIS 6.1 SPEC SHEET



PROFESSIONAL



OCULARIS PROFESSIONAL

The Ocularis platform is offered in three models – Professional, Enterprise and Ultimate – to meet the needs of organizations of all sizes and types.

Ocularis Professional is the powerful video management system that's hassle free in its implementation and easy to use in operation. From convenience stores to citywide deployments and everything in between, Ocularis can scale up to accommodate an infinite number of cameras to match your growing system needs.

Ocularis lets you record video from IP network cameras – as well as analog cameras cameras using encoders – putting you in control of advanced tools and enhanced integrations like smart motion detection, access control, and biometrics.

The Ocularis Professional model is designed for organizations operating at single or multiple locations with no size limitations. It supports live monitoring and playback with multiple investigation tools.

For the full list of features, see the Ocularis Architecture & Engineering (A&E) document, available by request.

FEATURES

EASILY CONNECT MANY SECURITY RELATED APPLICATIONS

The Event Interface (SEI) breaks new ground to connect Ocularis to third-party security products using a flexible, driver-based approach. All events from third-party applications such as access control, burglar alarm and many more can now be visualized within the Ocularis client, e.g. by displaying them in maps and floor plans or opening the relevant camera streams.

OPEN ARCHITECTURE FOR EASY INTEGRATIONS

With the newly available Analytics Interface (SAI), Ocularis now also provides an open and standardised interface for technology and solution partners to easily develop plugins to connect Ocularis with their product portfolios. By using the SAI, any edge or server-based analytics solution on the market can now be easily integrated.

COMPOSITE EVENTS ('EVENT FUSION')

Composite Events are created by linking two events or alerts, configured by sequence order, time interval and logical conditioning (e.g. 'If Door "A" opens, but no motion detection on Camera "N", within 15 seconds'). Composite Events can be fused with other events to create complex detection scenarios, and assigned priority for push video and handling by Ocularis Client operators.

NO PROPRIETARY HARDWARE REQUIREMENTS

Ocularis runs on non-proprietary, off-the-shelf PC hardware and is also supported in virtual environments such as Microsoft Hyper-V and VMware. Ocularis supports the leading manufacturers' cameras and devices—including almost all embedded analytics and features—as well as the ONVIF and ONVIF Profile S standards allowing you to use the right camera technology for your application.

DYNAMIC DATA MANAGEMENT

Ocularis Professional features efficient and dynamic data management with automatic load balancing across multiple storage volumes with no archiving requirements.

END-TO-END DATA SECURITY

Ocularis uses modern TLS 1.2 encryption protocols to secure camera-to-server communications, server-to-server communications and Client-to-server communications. Recorded video is protected by utilizing a randomized data structure containing no camera identification information.

AUTOMATIC RECORDER PATCH UPDATES

Recorder patch updates are automatically downloaded and applied in Ocularis, keeping the system up-to-date and secure. Administrators may also choose to download and install patches manually. This is the only effective way to make sure all of your servers are updated 100% of the time.

VIDEO BACKUP

Automatically create a copy of your video data in another location - either on-site or off-site - to protect your important recordings. Video Backup can also be used with mobile NVRs in transportation applications to offload video from a bus, train, delivery van or patrol car to a central location for review.

FLEXIBLE RECORDING OPTIONS

Ocularis features both Standard (continuous) and Alarm Recording, based on motion detection or other alarm input. Each recording mode can be configured with different retention policies ensuring that all critical video data is captured and saved. Alarm Recording can also be configured to use a secondary stream for added recording flexibility and optimal utilization of storage.

PRO

ENT

ULT

FEATURES

SERVER-BASED DETECTORS

In addition to supporting camera-based motion detection and analytics, Ocularis also includes efficient server-based motion detection with multiple regions of interest, each with their own sensitivity and threshold adjustments. Ocularis also includes server-based tampering detection and reference image comparison to monitor the status of your cameras.

SYSTEM HEALTH MONITORING

Ocularis provides real-time and detailed information to system administrators including disk and bandwidth utilization, camera status, as well as email and SMS alerts upon errors and other issues.

SMART CAMERA DRIVERS

Smart Camera Drivers for Allnet, Arecont, Axis, Bosch, Convision, Canon, Dahua, Eclipse, FLIR, Grundig, Hikvision, Interlogix, Northern, Panasonic, Hanwha Techwin, Sony, THK Security, Vanderbilt, Vivotek and more to support almost all embedded analytics and features allowing full use of the camera's capabilities including the latest H.265 HEVC compression.

SUPPORT FOR THOUSANDS OF OTHER CAMERAS

Ocularis also supports thousands of cameras from dozens of technology partners with model-specific drivers and also includes full support for ONVIF and ONVIF Profile S compatible cameras. Ocularis's extensive camera support allows customers to choose the right camera for the application.

CRITICAL CAMERA FAILOVER

Ocularis features automatic switching of interrupted or disconnected video streams in any live view within 2-3 seconds—including maps and blank screen events—to designated alternate camera streams. This unique feature ensures operators never lose sight of the situation.

MULTI-STREAMING SUPPORT

Ocularis takes advantage of multiple streams from cameras to minimize bandwidth usage to web, mobile and desktop Clients. With automatic stream selection, Ocularis Client displays the optimal stream for viewing. Multiple streams can also be used to optimize recording by using a lower resolution for Standard Recording and a full resolution stream for Alarm Recording.

PTZ PRIORITY SUPPORT

When something important happens, it is critical that the correct user has exclusive control of the PTZ cameras. With PTZ priority values ranging from 1 – 99 as well as PTZ priority timeout values, it is easy to conform PTZ priority to any customer system.

USER AUDIT LOGGING

All user and administrator activity may be logged by enabling audit logging in Ocularis Base. A built-in query tool provides easy-to-read, color-coded results with export capability for further investigation and statistical reporting.

ACCESS VIDEO ANYWHERE

Ocularis Desktop, Web, and Mobile Clients are provided license-free so video can be accessed from virtually anywhere, at any time.

VIDEO PROTECTION MODE

One of the greatest fears of every system administrator is that sensitive video will be leaked to unauthorized parties or uploaded to social media. Such disclosure of video can result in bad PR, financial damages, or criminal charges. Ocularis allows the administrator to select which cameras have additional text overlays to minimize the risks and create deterrence, showing the user's name when viewing the camera in browse mode or when creating video exports.

 PRO

 ENT

 ULT

FEATURES

INTUITIVE UNIFIED DESKTOP CLIENT

Ocularis Client offers a user-friendly operator interface with support for up to 8 displays with independent functionality and both local and remote video wall control..

ADVANCED WEB AND MOBILE CLIENTS

Up to 16 cameras can be viewed live in both the Ocularis Web Client and Mobile apps. Playback, Alert Handling and AVI Export are also supported. Ocularis Mobile apps are available for Android and iOS devices free of charge and the Web Client supports multiple browsers across Mac and PC.

UNLIMITED SHARED AND PRIVATE VIEWS

On the desktop, Ocularis Client users can create and save an unlimited number of views of different sizes (up to 8 x 8 panes), consisting of camera streams, carousels, hotspots, web pages and Blank Screen panes for receiving automatic (on-event) and manual (peer-to-peer) push-video alerts.

LIVE MONITORING WITH INSTANTANEOUS INVESTIGATION

While monitoring live video feeds, users can perform basic investigation on individual cameras—playback, digital PTZ and optical PTZ (for PTZ cameras)—without the need to switch to a dedicated investigation mode.

EXCLUSIVE INVESTIGATION TOOLS

Ocularis Client's dynamic TimeSlicer™ can shorten investigation time to seconds instead of hours or even days by quickly showing thumbnails in different time steps or via built-in motion detection. The Kinetic Timeline™ provides fast access to continuous historical data with a backwards and forwards swipe navigation and color codes to help identify recorded video.

360-DEGREE CAMERA DEWARPING

Ocularis Client features native dewarping of 360-degree cameras from ACTi, Axis, Bosch, OnCam Grandeye, Panasonic, Pelco, Samsung, Sentry 360, and Vivotek as well as for cameras equipped with the ImmerVision Panamorph lens.

EMBEDDED INTEGRATION WITH BRIEFCAM ANALYTICS

Use a market-leading analytics solution inside Ocularis Client. All Ocularis and BriefCam user functionality is available together inside the same user-interface.

SHARED EVENT HANDLING

All events generated within the Ocularis system—or integrated 3rd-party systems—can be handled from any Client with real-time alerting via pop-up video in the desktop Client, notifications on the Mobile Clients or pop-up alerts on the Web Client. Alerts can also be displayed on maps and shared with 3rd-party systems.

CAPTURE VIDEO ON-THE-SPOT

With M2O™ (Mobile-to-Ocularis), mobile devices can be used to stream video into Ocularis*, just like another IP camera.

*Requires a camera license.

○
PRO

○
ENT

∞
ULT



SYSTEM DIAGRAM

○
PRO

○
ENT

∞
ULT

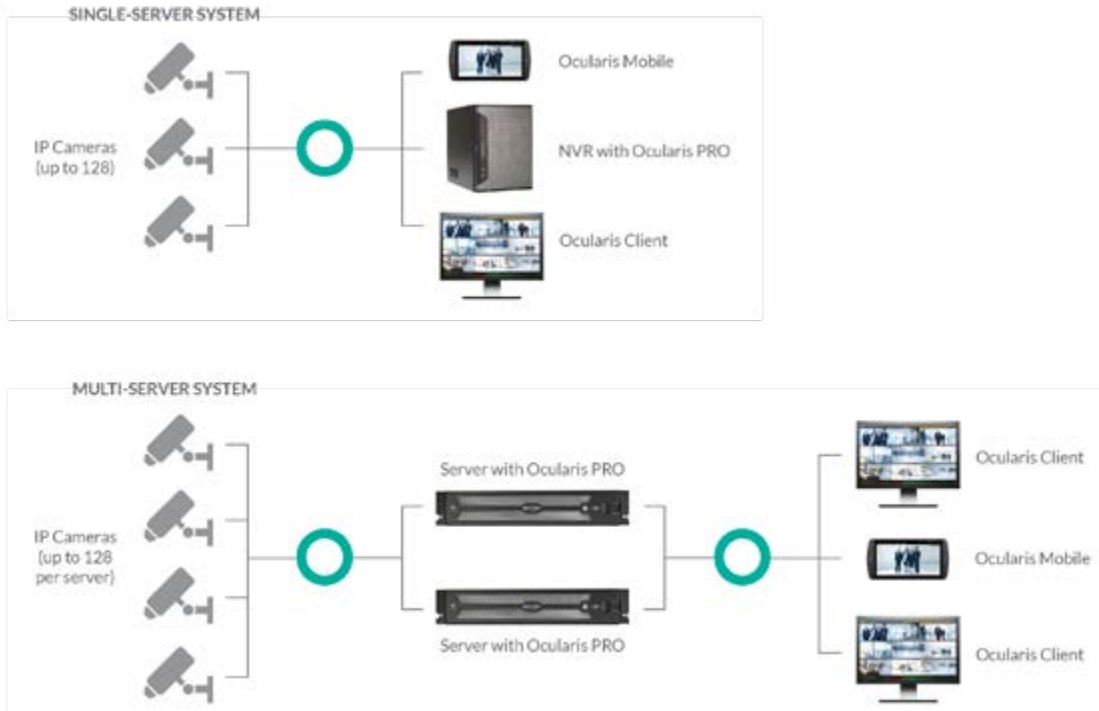

* In smaller systems, all Ocularis components may be installed on the same PC/server.

SYSTEM COMPONENTS

OCULARIS CLIENT

Unified operator interface for live monitoring, playback and investigation, alert management, map navigation and local VideoWall control for workstation connected displays.

OCULARIS BASE

Manages the flow of event, user and system status data from the various system components. Provides Active Directory authentication for Client operators.

OCULARIS RECORDER

Manages camera connections, recording parameters and video data.

OCULARIS MEDIA SERVER

Enables web and mobile access to video and alerts and also serves as the gateway for M2O™ video from mobile devices.

FEATURE SET COMPARISON



OCULARIS SYSTEM FEATURE	PROFESSIONAL	ENTERPRISE	ULTIMATE
Number of cameras per system	Unlimited	Unlimited	Unlimited
Number of recorders per system	Unlimited	Unlimited	Unlimited
Number of concurrent client connections	Unlimited	Unlimited	Unlimited
Ocularis Mix & Match - combining multiple recorder types in a single system	Yes	Yes	Yes
Ocularis OpenSight™ option for sharing video between Ocularis systems	Remote	Remote	Main/Remote
Critical Camera Failover for camera failure protection	Yes	Yes	Yes
Centralized user management with color-coded audit logging of user activity	Yes	Yes	Yes
Includes Active Directory support for secure system access	Yes	Yes	Yes
Data Link and Network I/O event integration	Yes	Yes	Yes
Event Fusion / Composite Events	Yes	Yes	Yes
Ocularis Web and Mobile Clients included with optional M2O (Mobile-to-Ocularis) video streaming	Yes	Yes	Yes
PTZ Priority	Yes	Yes	Yes
OCULARIS CLIENT FEATURES			
License-free and unlimited Ocularis Client installations and connections	Yes	Yes	Yes
Multi-level map navigation with live camera previews	Yes	Yes	Yes
Support for 8 independently controlled displays from a single workstation	Yes	Yes	Yes
Embedded Integration with BriefCam Analytics inside Ocularis Client	Yes	Yes	Yes
Remote VideoWall function for command and control centers	No	Optional	Standard
Dynamic TimeSlicer™ thumbnail search and Kinetic Timeline™ for quick and easy investigations	Yes	Yes	Yes
Create, save, and manage unlimited shared and private views	Yes	Yes	Yes
TLS 1.2 encryption for client-server communications	Yes	Yes	Yes
Secure multi-camera database export with included Viewer (with or without audio)	Yes	Yes	Yes
Snapshot still image export and printed incident report	Yes	Yes	Yes
Single camera AVI export capability (with or without audio)	Yes	Yes	Yes
Multi-camera Bookmarking function to preserve important video	No	Yes	Yes
Support for USB joysticks for PTZ control	Yes	Yes	Yes
Alert management with support for metadata overlays on maps and video	Yes	Yes	Yes
Video Flagging to quickly and easily mark a moment in time for later review	No	Yes	Yes
One-File Export to easily and securely share video evidence with third parties	No	Yes	Yes
Video Protection Mode	Yes	Yes	Yes
OCULARIS RECORDER FEATURES			
Number of cameras per server	128	500	500
Centralized recorder management	No	Yes	Yes
Fully redundant recorder manager without using clustering	No	Yes	Yes
Automatic recorder patch update service	Yes	Yes	Yes
Automatic failover of recording servers	No	Yes	Yes
Efficient and dynamic data load balancing with no archiving requirements	Yes	Yes	Yes
Video data aging (grooming) for long term storage optimization	No	No	Yes
Automatic mirroring of video data to failover recorder for complete redundancy	No	No	Optional
Automatic edge recording retrieval after network disconnect	No	Yes	Yes
Automatic Video Backup of important data to another location	Yes	Yes	Yes
Support for H.265, H.264, MPEG-4, MJPEG, and MxMPEG compression formats	Yes	Yes	Yes
Support for camera-based analytics including Axis Dynamic Event Stream	Yes	Yes	Yes
Server-based motion detection, tampering detection and reference image comparison	Yes	Yes	Yes
Support for thousands of IP cameras plus ONVIF, ONVIF Profile S, generic RTPSP and MJPEG drivers	Yes	Yes	Yes
Smart Camera Drivers for most major camera manufacturers (See our supported devices list on the web for complete details)	Yes	Yes	Yes
Support for multi-streaming from cameras for efficient bandwidth utilization	Yes	Yes	Yes
TLS 1.2 and HTTPS (SSL) encryption for camera to recorder communication	Yes	Yes	Yes
License-free digital input/output device support (number of devices)	5	Unlimited	Unlimited
Simultaneous Standard and Alarm Recording with separate retention policies	Yes	Yes	Yes
Incoming audio recording for supported cameras	Yes	Yes	Yes
Two-way audio support for select cameras and audio only devices	Yes	Yes	Yes
Multicast live view from recorder to Ocularis Client	No	No	Yes

SYSTEM REQUIREMENTS

SUPPORTED OPERATING SYSTEMS (ALL 64-BIT)

- Microsoft Windows 10 (Updates: Anniversary, Creators, Fall Creators) (Professional, Enterprise)
- Microsoft Windows Server® 2012 (Standard, Datacenter)
- Microsoft Windows Server® 2012 R2 (Standard, Datacenter)
- Microsoft Windows Server® 2016 (Standard, Datacenter)
- Microsoft Windows Server® 2019 (Standard, Datacenter)

HARDWARE RECOMMENDATIONS

All Ocularis components may be installed on the same PC/server

OCULARIS BASE*

- CPU: Intel Core i3 or better
- RAM: 8 GB
- Hard Drive: Minimum 250 GB
- Software: Microsoft .NET 4.6.2 Framework; IIS 6.0 or newer

OCULARIS RECORDER*

Recommended:

- CPU: Intel Core i7-4930K @ 3.40GHz or Intel Xeon E5-2640 v3 @ 2.60GHz
- RAM: 16 GB
- HDD: 500 GB free disk space @ 7200 RPM for OS and Applications Additional storage as required for video storage
- Network: Ethernet with 1000 MBit/s. Do not team NIC's except for fault tolerance (Bandwidth aggregation not supported)

Minimum:

- CPU: Intel Core i3 M 370 @ 2.40GHz
- RAM: 8 GB
- HDD: 100 GB free disk space for OS and Applications
- Additional storage as required for video storage
- Network: Ethernet with 1000 MBit/s. Do not team NIC's except for fault tolerance (Bandwidth aggregation not supported)

OCULARIS MEDIA SERVER*

- CPU: Intel® Xeon® E3 Series or Intel® Core™ i5 (or better) recommended
- RAM: Minimum 8 GB (reserve 4GB for Ocularis Media Server if installing with other Ocularis applications)
- Hard Drive: 50GB or more
- Software: Microsoft, .NET 4.0 Framework, .NET 4.6.2 Framework and Internet Information Services (IIS) 6.0 or newer

OCULARIS CLIENT**

- CPU: Intel Core i5™ or better
- RAM: 8 GB minimum (16 GB or more recommended)
- Software: DirectX 9.0 or newer, Microsoft .NET 4.6.2 Framework
- Graphics Adapter: PCI-Express, minimum 256 MB RAM

*May be installed on the same PC/server (all-in-one system) and is also supported in virtual environments

** Supported in virtual environments

Please visit the Online Storage and Hardware Calculator for detailed system requirements or contact us.

○
PRO

○
ENT

∞
ULT



www.qognify.com

© All rights reserved to Qognify Limited and its affiliates ("Qognify"). For the full list of Qognify's trademarks, please visit www.qognify.com/trademarks. All other marks used are the property of their respective proprietor.

